



Since 1963

Beaver Stand

[ASSEMBLY INSTRUCTIONS]

If you have any questions or require assembly assistance, please contact us for technical support.

BEAVER TECHNICAL SUPPORT

Phone: 905.836.4700 CDN & INT'L
800.265.6772 USA

Fax: 905.836.4737

Email: sales@beavervending.com

HOURS OF OPERATION

Monday – Thursday: 8AM – 4:30PM EST

Friday: 8AM – 11.30AM EST

WWW.BEAVERENDING.COM

BS250 D

[Five Machines]



BS250 D

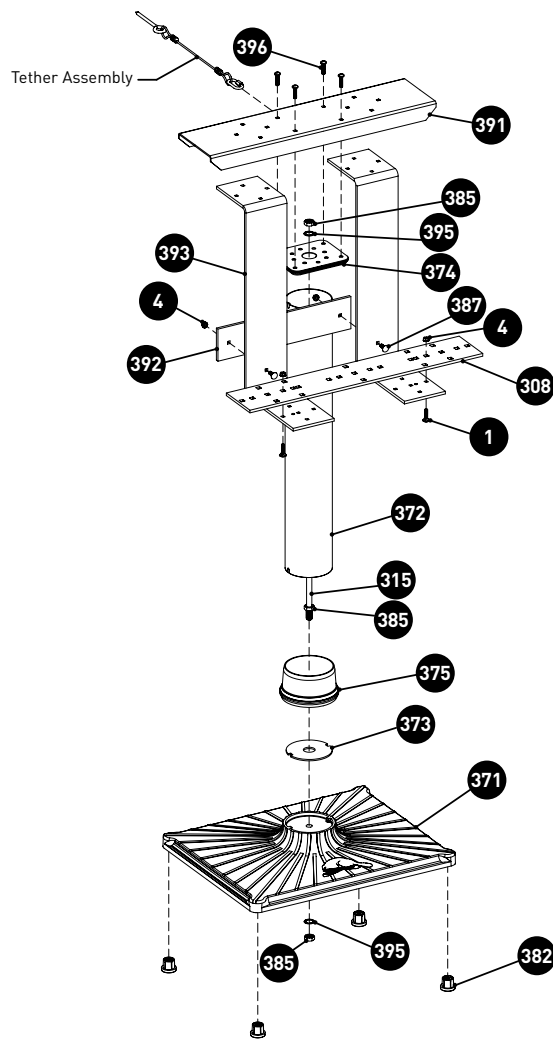

→ BS250 D (Five Machines)

ASSEMBLY INSTRUCTIONS

****REQUIRED TOOLS (NOT SUPPLIED):** 3/4" DEEP SOCKET, 7/16" WRENCH OR SOCKET, ROBERTSON SCREW DRIVER (SIZE #2, SQUARE TIP) & VISE-GRIP PLIERS

1. Take Center Rod (315) with a pre-installed Hex Jam Nut (385) and insert into the Base (371).
2. Place a Star Washer (395) and a Hex Jam Nut (385) onto the bottom portion of the Center Rod (315) that is protruding from the bottom of the Base (371).
3. Using the Vise-Grips, clamp the Center Rod (315), and using the 3/4" Wrench or Socket, tighten the BOTTOM Hex Jam Nut (385). Do NOT torque the top Jam Nut!
4. Slide the Gasket (373) on the Center Rod (379) and line up with the notch in the Base (371).
5. Slide the Tulip (375) and the Pipe (372) over the Center Rod (315) and locate onto the Base (371) by lining up the notches.
6. Place the Flange (374) on top of the Pipe (372), lining up the notches.
7. Install the remaining Star Washer (395) and Hex Jam Nut (395) on the top of the center rod, and tighten it. NOTE: A wrench or socket may be used on each end of the Center Rod (379) to help ensure that the rod does not spin while tightening the upper nut.
8. Using the supplied 7/8" Robertson Screws (396), bolt the Double Bar (391) to the Flange (374). Screws should be inserted from the top. NOTE: The hole in the cross bar faces the back of the stand.
9. Remove the Mounting Plate (200) from the bottom of your Northern Beaver series machine. For more information regarding the Mounting Plate (200) please refer to your machine's owners manual.

Thank you for purchasing a Beaver BS250 D Stand!

Please read through the instructions carefully, prior to assembly, to help ensure the stand is easily and correctly put together.

PARTS LIST

NOTE: Please double check to ensure all parts are accounted for before discarding packaging.

Part Name	Ref Number	Order Number	Qty Required
Center Rod	315	55100017	1
Star Washer	395	50100010	2
Gasket	379	50100099	1
4" Diameter Pipe	372	50100100	1
Cast Iron Base	371	50100101	1
Tulip	375	50100102	1
Feet(Pre-Installed)	382	50100091	4
1/2"x13 NC Hex Jam Nut (1 Pre-Installed)	385	50100103	3
Double Bar	391	50100107	
Triple Bar	308	50100005	1
7/8" Robertson Screw	396	55100058	4
S Bracket (left)	393L	50100106	1
S Bracket (right)	393R	50100107	1
Brace	392	50100108	1
1/4" x 20 Nut	4	50100021	22
3/4" Carriage Bolt	387	50100015	12
1" Carriage Bolt	1	55100015	10
Security Tether Kit	N/A	50160005	1

10. Place the Left S Bracket (393L) under the Double Bar (391). Place the Mounting Plate (200) on top of the Double Bar (200). Line up the holes on all three pieces. Insert four 1" Carriage Bolt (1) into the holes. Repeat for the Right S Bracket (393R). NOTE: Tighten only by hand to allow for bracket flex during continuation of assembly.
11. Bolt the Brace (392) on the back of the S Brackets (393L/R). Insert one 3/4" Carriage Bolt (387) on each side from the front. Place a 1/4" Nut (4) on each. NOTE: Tighten only by hand to allow for bracket flex during continuation of assembly.
12. Place the Triple Bar (308) on top of the lower part of the S Brackets. Line up the holes and insert one 1" Carriage Bolt (1) through each of the S Brackets. Insert from the bottom. Place a 1/4" Nut (4) on each. NOTE: Tighten only by hand to allow for bracket flex during continuation of assembly.
13. Disassemble your RB Series machines. For more information regarding taking your machines part, please refer to your machine's owners manual.
14. Locate the base of one of the machines in the center of the Triple Bar (308), lining up with the bolt holes. Next, place the bases for the two remaining machines on either side of the center base, lining up the holes on the Triple Bar (308).
15. Bolt the machine bases to the Triple Bar (308) following the directions provided in your machine's owners manual.
16. Tighten all bolts that were previously hand tighten.
17. Your stand is now assembled and ready to have the machines and Security Tether installed. Please see detailed installation instructions included with these components.